

INSTALL INSTRUCTIONS

Part #s 42279 & 42279-D

Banks Ram-Air® Intake System
2019-2022 Ram 2500/3500
6.7L Cummins

Please read through the following instructions thoroughly before starting your installation. If you have any questions please visit our [Support Page](#).



Tools required:

10mm socket
1/4" Ratchet
Philips Screw Driver
Flat Head Screw Driver

Recommended:

Plastic Panel Popper Tool
5/16" Nut Driver





<https://vimeo.com/649215813>



Section 1: General Assembly

Bill of Materials

Item	Description	Part #	Qty.
1	Machine Screw, 1/4-20 X 3/8	91128	4
2	Window	41788	1
3	Housing	42281	1
4	Air Filter	42259 (-D)	1
5	Hose Clamp #104	92904	1
6	Tube	42280	1
7	Screw, M4 X .7 X 16mm	91924	1
8	Screw, M4 X .7 X 8mm	91918	2
9	Hose Clamp #72	92872	2
10	Hose	94058	1



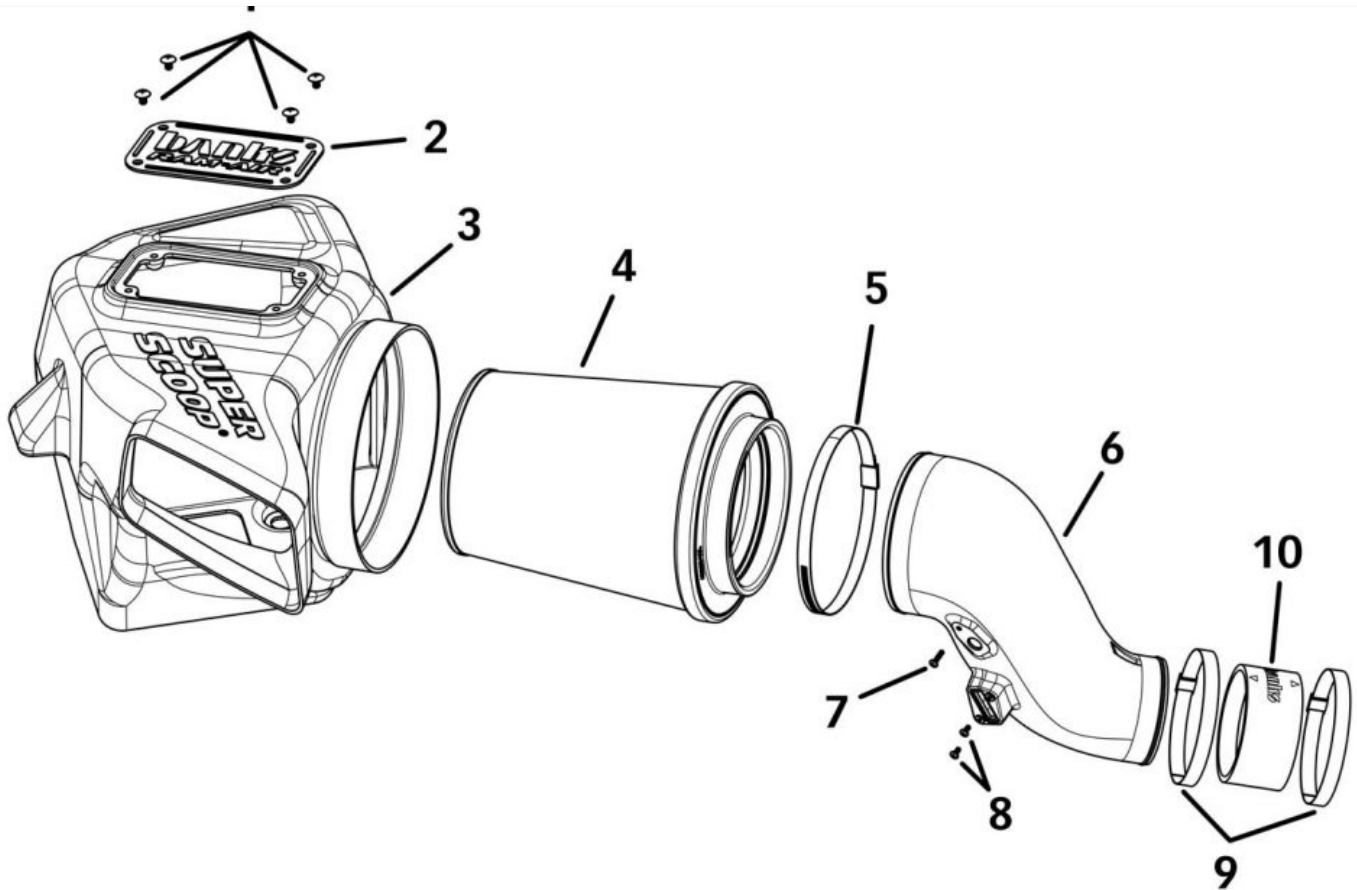

[General Installation Practices - Show](#)





Tools Required:

10mm Socket
5/16" Socket
Ratchet Extension
1/4" Ratchet
Philips Screw Driver
Flat Head Screw Driver

Recommended:
Plastic Panel Popper Tool
5/16" Nut Driver

Section 2: Stock Intake Tube Removal

Use caution when working in the engine compartment. Make sure the engine has been OFF for several hours and cool. Some components from the stock air intake system will remain in service. Take care when removing stock air intake components to not damage them.





1. Disconnect negative battery cables. (both batteries)

NOTE: Wait for **15 minutes** before proceeding to allow the ECM to fully discharge.

Disconnecting sensors before the ECM is fully powered down can result in Check Engine Codes or starting in "Limp Mode" after install is complete.



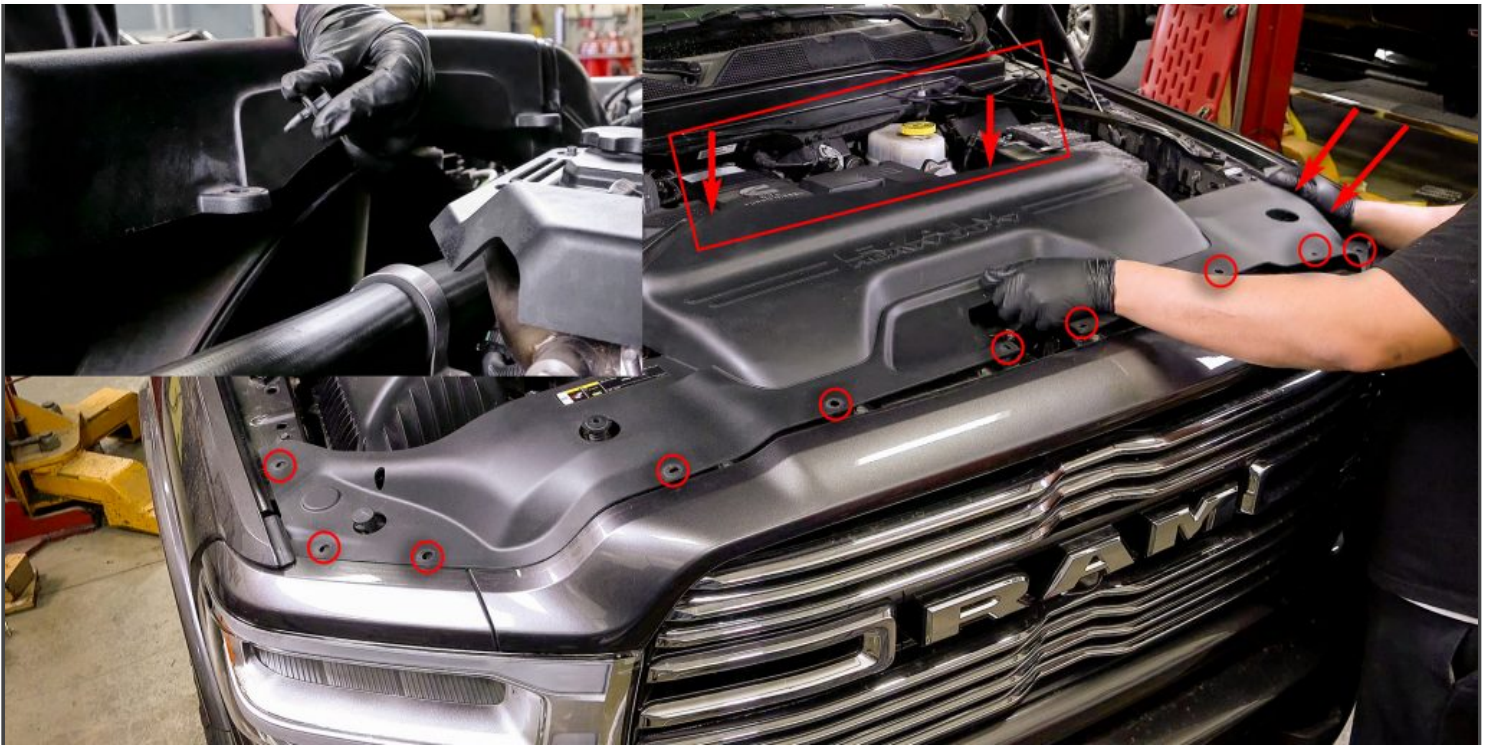

2. Remove OEM intake scoop cover

There are 12 plastic clips. Use a plastic panel popper tool to avoid damage to the cover.

Note: 2 are located behind the scoop.

Save the clips to be reused.





3. Disconnect the two sensors located on the intake housing lid.

- a. First slide the harness clip free from the housing lid.
- b. Then pull the retainer clip holding the harness to the scoop using a panel popper.
- c. Pull the harness clear of the intake.





4. Detach the OEM scoop from the truck

Remove the two bolts on either side of the scoop. Use a 10mm socket and ratchet.

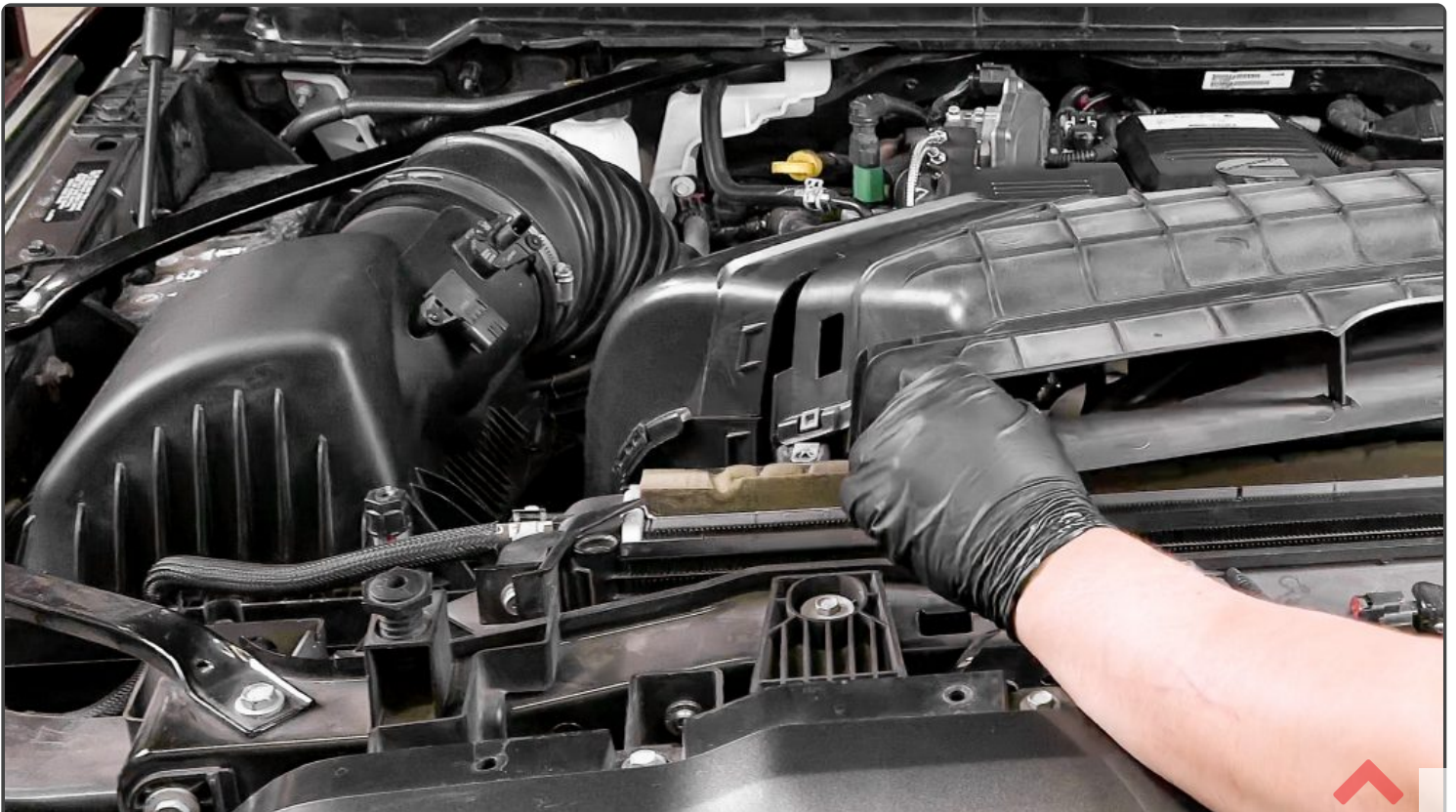

Note: The scoop will be reused with the Banks Ram-Air system.

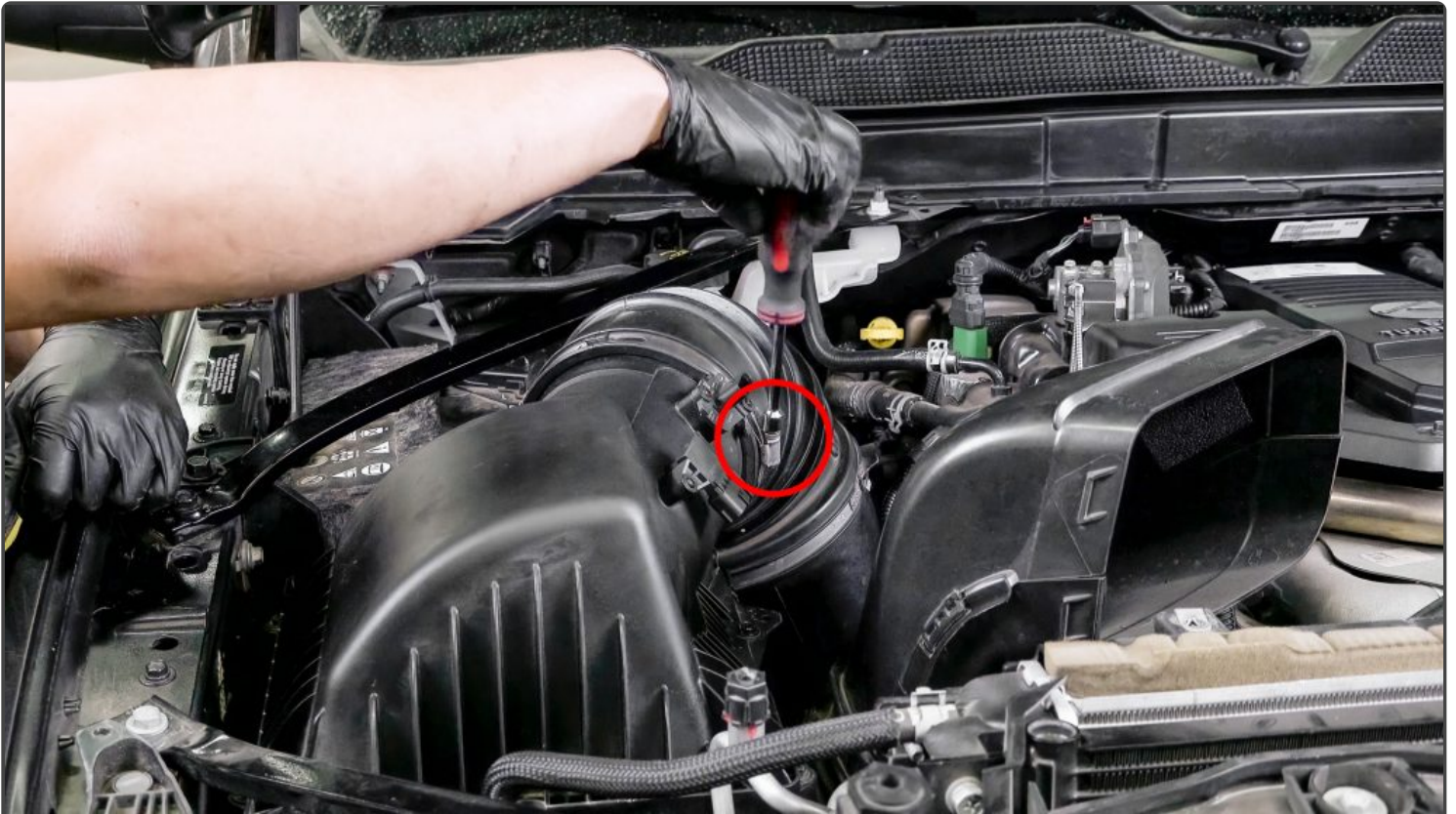

6. Detach the intake tube from housing

Use a 5/16" nut driver or screwdriver to loosen the hose clamp holding the intake tube onto the housing lid.



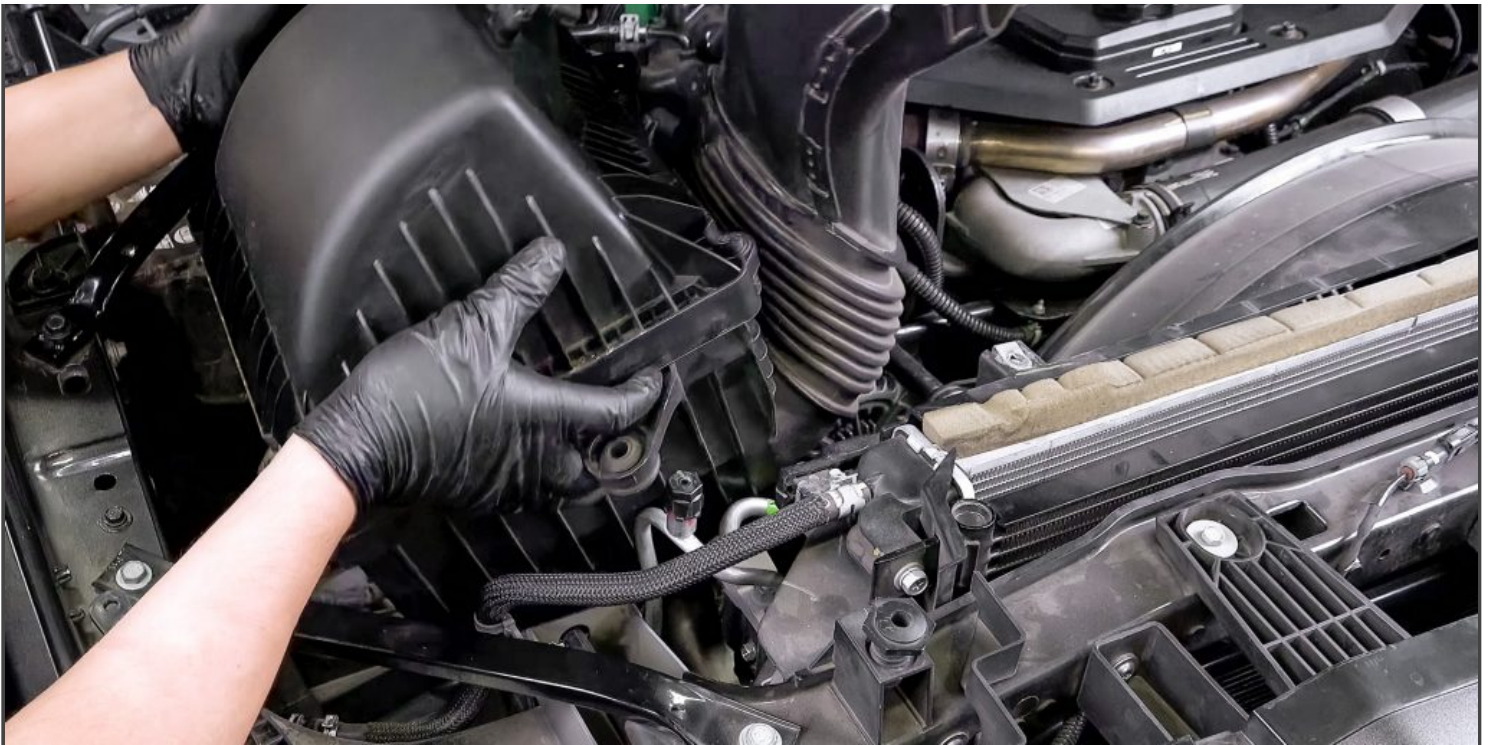

7. Remove housing and scoop

Pull the intake housing and scoop out of the engine bay.



Loosen the hose clamp holding the intake tube onto the turbo. Use a 5/16" socket with an extension and ratchet or 5/16" nut driver.

Section 3: Installing the Banks Ram-Air Intake

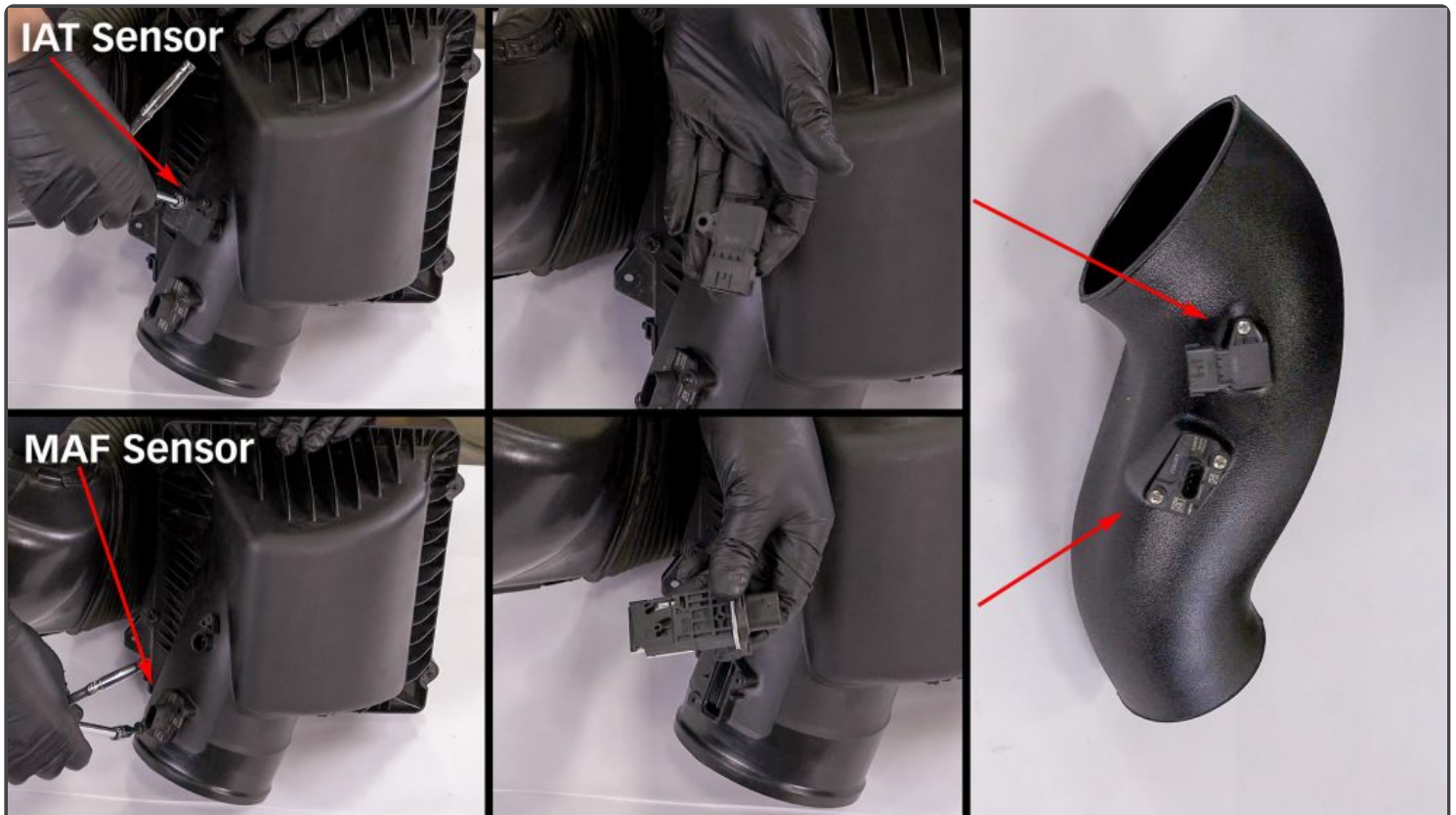

9. Transfer the (MAF) and (IAT) sensors onto the Banks tube.

Note: The Mass Air Flow sensor uses two M4x8mm screws while the Intake Air Temperature sensor uses one M4x16mm screw.





10. Transfer grommets to the Banks Ram-Air Intake housing.

There are three grommets that need to be transferred from the factory intake housing to the Banks Ram-Air Intake housing





11. Drop the housing into place.

Make sure that all three grommets are seated.



Slip the Banks hose onto the turbo with the arrow aligned to the breather hose on the turbo.

Banks Intake Side



Line up intake tube lip
into this groove
(shorter side)

Compressor Side

line up turbo inlet lip into this groove
(Longer side)

Note: Make sure the internal groove of the hose clears the end of the turbo inlet.





13. Slip clamps onto the hose.

Tighten the hose clamp on the turbo side. Leave the outer clamp loose.



Insert filter into the Banks housing and place the large hose clamp over the filter cuff.



15. Slip the Banks intake tube into the filter cuff.

Do not tighten the clamp.





16. Slip the opposite end of the tube into the hose on the turbo.

Note: Make sure the alignment arrow on the hose, lines up with the dimple on the Banks intake tube.

17. Check the alignment of the tube:





18. Tighten the clamp on the Banks intake tube hose.

Check that the alignment arrows are still pointing at the dimple on the Banks intake & the breather hose on the turbo.





19. Plug in the MAF and IAT sensors.



Make sure the sensor harness is tucked against the intake housing and away from moving parts.



21. Reinstall the factory scoop.

First, slide it over the Banks' Super Scoop. Then, position it into place and reinstall the two bolts on either side of the scoop.





22. Reinstall the scoop cover.

Use the original clips.



housing.

Use the supplied thread locker with the four Philips head screws.

Note: Do not over-tighten the screws. They should only be snug. The thread locker will prevent them from coming loose.



24. Re-connect negative Battery Terminals.

Verify terminals are attached firmly to prevent corrosion or electrical faults.
Start your truck and enjoy your new Banks Power Ram-Air intake.

[← 97278 AutoMind Programmer – Section 10 – Tuning Levels Explained](#)

[97278 AutoMind Programmer – Section 9 – Advanced Tuning Options Explained →](#)

 You May Also Like



FILTER CLEANING

Frequently Asked
Questions: Ram-Air IntakesNEED HELP? Call **800-601-8072** from 7am-5pm Pacific.Latest Videos[View All](#) Subscribe to Banks Power
channelHow to prevent RAM 6.7L grid heater
bolt failureHow Banks got into diesel | Speed
School Podcast Ep 13Pics or it didn't
happen!

bankspower

Turbochargin' since '58.

#bankspower

#banksbuilt

#houseofhorsepower

#galebanks

#galebanksracingengines

#banksspeedschool

[Load More...](#)[Follow us on Instagram](#)

★ Popular

↺ Recent

6.6L
Crate
EngineOwners
ManualsDerringer L5P
Tuner
for the
2017-
2019
Duramax

x: Real Power is here!

Why
EGT is
Importa
nt

Questions?

Ask us anything.

Power...

Durability...

Efficiency! You want it, we have it!!

Nobody knows it better than us.

[Privacy Policy](#)[Sitemap](#)

Contact Us

Call 800-601-8072

Mon-Fri 8am-5pm
Pacific Time[Send us a message](#)

Fax 626-691-2122

546 S Duggan
Avenue
Azusa, CA 91702[Map/Directions](#)

Looking to buy Banks?

[800-601-8072](#)
[CALL NOW OR VISIT US](#)[800-601-8072](#)
[CALL NOW](#)[Shop online 24/7](#)or visit our
PowerHouse

I've raced & built engines since '56. Since '65 my favorite performance tool has been the turbocharger, I boosted my first diesel in '78, set a few records too!

Our mission is to improve performance, durability and the driving experience, all without compromising emissions requirements.

Gas & Diesel Performance for Cars, Trucks, Jeeps and Motorhomes

Copyright © 2022 Gale Banks Engineering. All rights reserved.

